

# Modular Generator Panel



## MGC920

- Select AC Meter Module Only or Add Engine Module for Manual or Auto Start
- Compact
- Full Featured
- Modular

The MGC920 series Modular Generator Panel allows you to select an AC meter module only or add an engine module for manual or automatic start. It is suitable for 1-phase, 3-wire or 3-phase, 4-wire generators. Current transformers (CT's) are not included.

### AC Meter Module

- AC voltmeter, 3-1/2 in (89 mm) dial,  $\pm 2\%$  full scale (specify range).
- AC ammeter, 3-1/2 in (89 mm) dial,  $\pm 2\%$  full scale (specify range).
- AC frequency meter, 120 V, 3-1/2 in (89 mm) dial,  $\pm 0.6$  Hz, pointer type, 45-65 Hz.
- Frequency meter rheostat.

### Optional Engine Module

- **Auto-start Module Panel** can be bolted to the AC module to provide automatic engine control capabilities. The auto-start panel includes the following features.
  - ASM150, auto-start controller with:
    - Optically isolated noise resistant inputs.
    - 300 mA transistor output for fault annunciator/TATTLETALE®.
    - Crank/rest cycle timer, 4 to 25 seconds (adjustable).
    - Shutdown time delay, 1 to 25 seconds (adjustable), locks out low oil pressure and high temperature on start-up.

– Crank disconnect and overspeed sensing switches that operate from a magnetic pickup signal, (requires 2 Vrms minimum).

- Auxiliary starter relay.
- Oil pressure SWICHGAGE®, 2 in. (51 mm) dial, 0-100 psi (0-689 kPa).
- Temperature SWICHGAGE®, 2 in (51 mm) dial, 70-230°F (21-110°C), 12 ft. (3.7 m) capillary.
- TEST-OFF-AUTO selector switch.
- Two (2) 2-1/16 in. (51 mm) diameter holes, plugged.
- **Manual Start Module Panel** can be bolted to the AC module to provide manual start engine control. The manual start panel includes the following features.
  - Power OFF-ON toggle switch and start push button.
  - 518APH TATTLETALE® annunciator.
  - Auxiliary starter relay.
  - Oil Pressure SWICHGAGE®, 2 in (51 mm) dial, 0-100 psi (0-689 kPa).
  - Temperature SWICHGAGE®, 2 in (51 mm) dial, 70-230°F (21-110°C), 12 ft. (3.7 m) capillary.
  - Two (2) 2-1/16 in. (52 mm) diameter holes, plugged.

### Options

- AC ammeter-voltmeter phase selector switch. Requires 2 additional CT.
- AC instrument circuit breaker (in lieu of fuses).
- Hourmeter, 2 in. (51 mm) dial, 5-digit.
- Battery voltmeter, 2 in (51 mm) dial (range determined by battery voltage).
- Battery ammeter, 2 in (51 mm), 60-0-60.
- Air dampener closed relay.
- Glow plug module.
- 14 x 12 in. (343 x 305 mm) weathertight enclosure.

### Warranty

A two-year limited warranty on materials and workmanship is given with this Murphy product. Details are available on request and are packed with each unit.

# Dimensions

## MGC920 Standard Enclosure

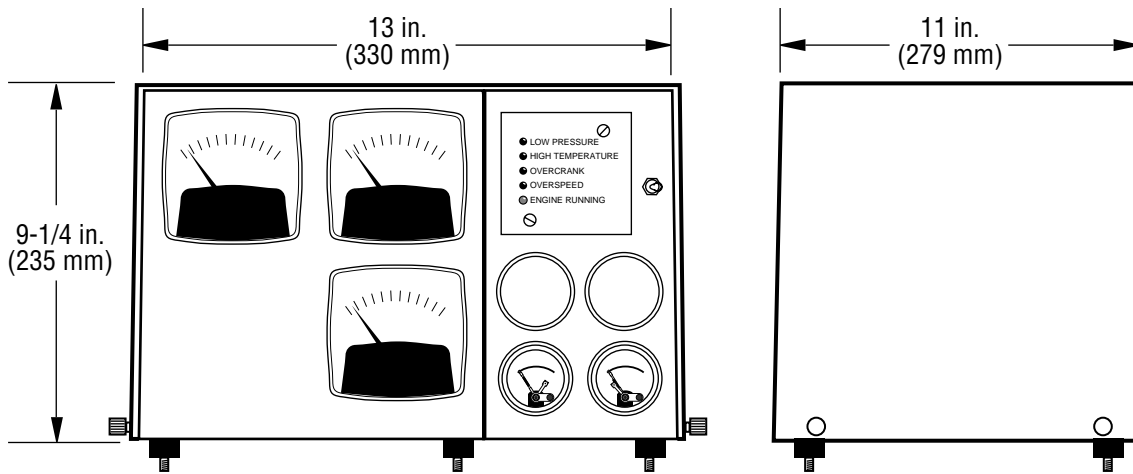

## MGC920 Weathertight Enclosure

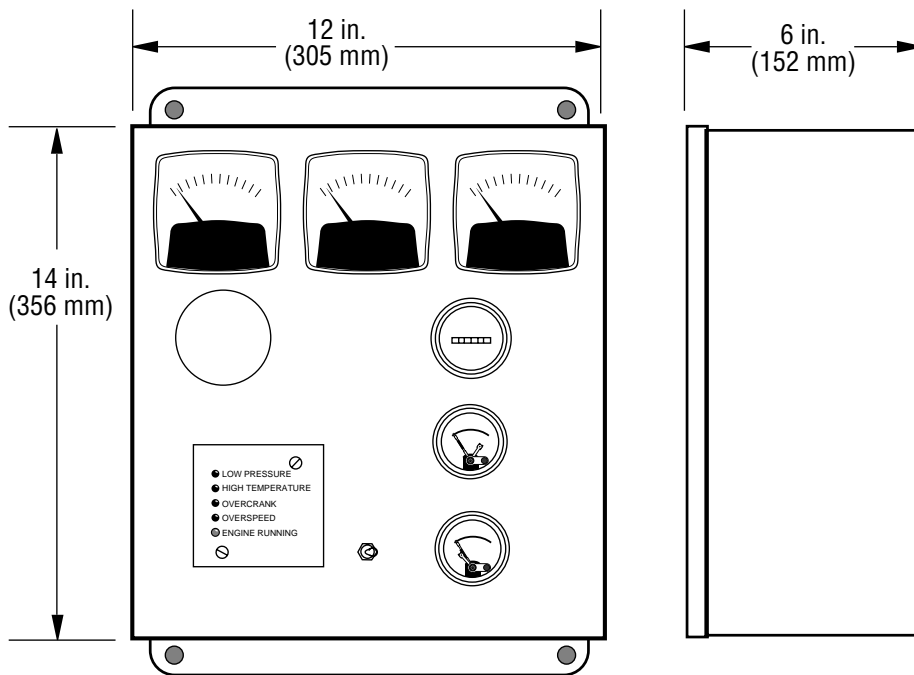

To order the MGC920, see "MGC920 Specification and Ordering Information" manual.